

MODIFIED J-CHANNEL, FILL SPACE BETWEEN J-CHANNEL & PANEL SEAM WITH URETHANE SEALANT

APPROPRIATE FIRESTONE ANCHOR FASTENER

RIDGE/HIP CAP

1/4" DIA. BEAD OF BUTYL SEALANT

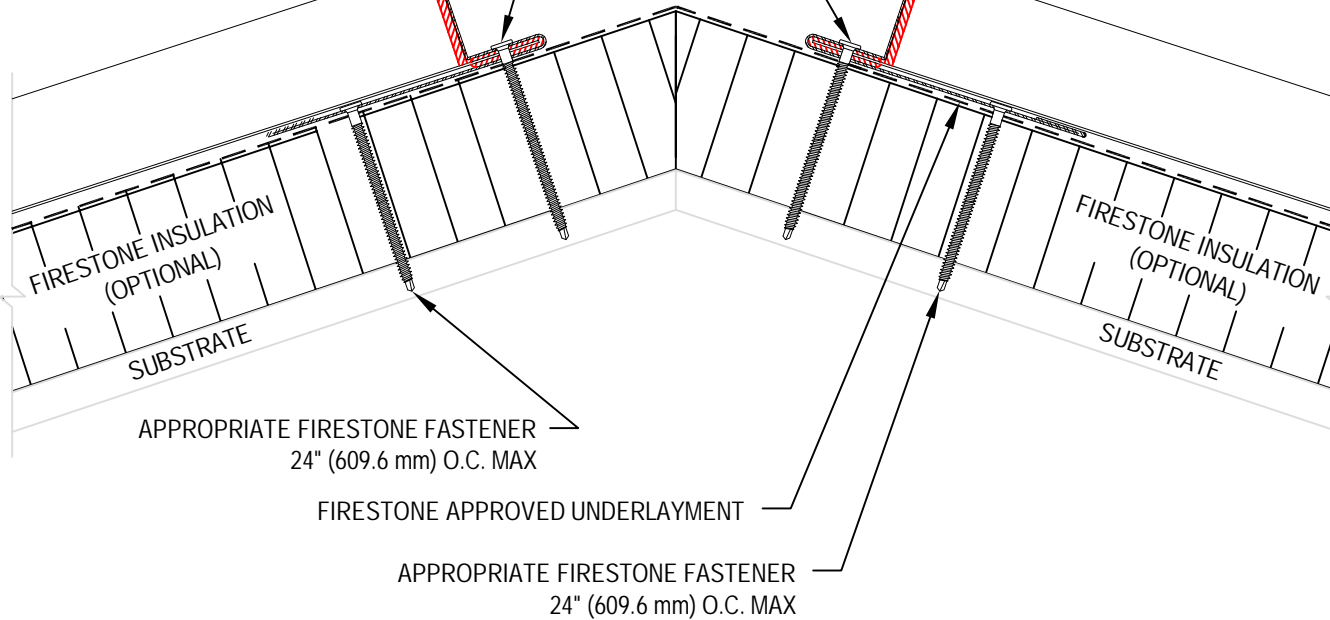

NOTES:

1. REFER TO FIRESTONE WEBSITE FOR MOST CURRENT INFORMATION.
2. REFER TO TECHNICAL INFORMATION SHEETS FOR FASCIA SIZES, ACCESSORIES, AND FINISHES AVAILABLE.
3. WOOD NAILER MUST BE INSTALLED TO MEET APPLICABLE BUILDING CODES OR 200 LBS PER LINEAR FOOT MINIMUM IN ANY GIVEN DIRECTION.
4. REFER TO THE FIRESTONE TECHNICAL DATABASE FOR FASTENER COMPATIBILITY WITH METAL.
5. APPLICATION DETAILS ARE FOR ILLUSTRATION PURPOSES ONLY AND MAY NOT BE APPROPRIATE FOR ALL BUILDING DESIGNS AND CONDITIONS.

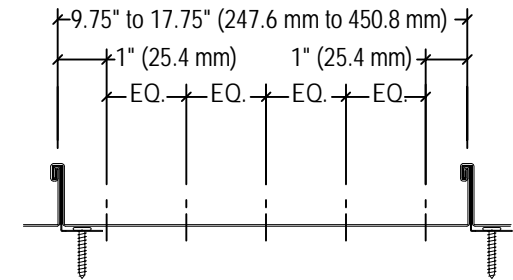

FASTENER SEQUENCE
FASTENER SPACING NOT TO EXCEED 4" (101.6 mm)

ANCHORING FASTENER PATTERN

FOR WARRANTY PERIODS GREATER THAN 20 YEARS REFER TO METAL QUICK SPECS FOR MINIMUM REQUIREMENTS.

MAXIMUM WARRANTY: 20 YEARS

Firestone
BUILDING PRODUCTS
NOBODY COVERS YOU BETTER.™
www.firestonebpco.com

FIXED HIP OR RIDGE WITH MODIFIED J-CHANNEL

UNA-CLAD®

ACCEPTABLE SYSTEMS: UC-4 RS

ISSUE / REVISION DATE:

08/30/2013

NOT TO SCALE

DETAIL NO.

4-R-2