

UNDER NO CIRCUMSTANCES CAN THE PIPE PENETRATE OR COME WITHIN 4" OF THE PANEL SEAM.

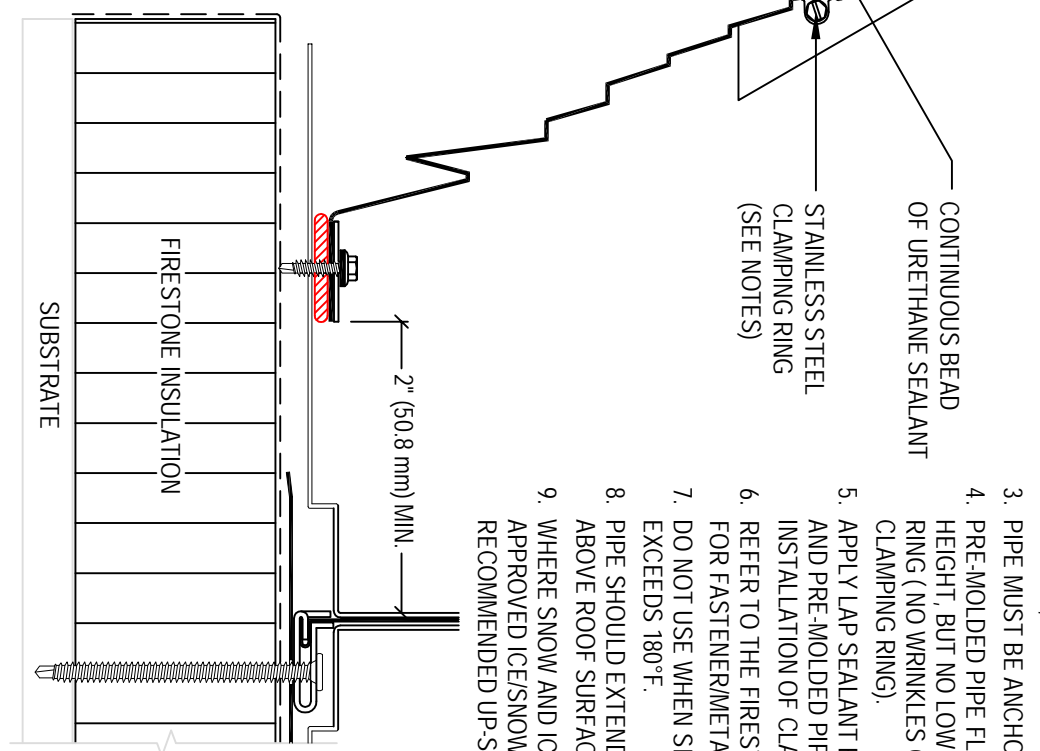
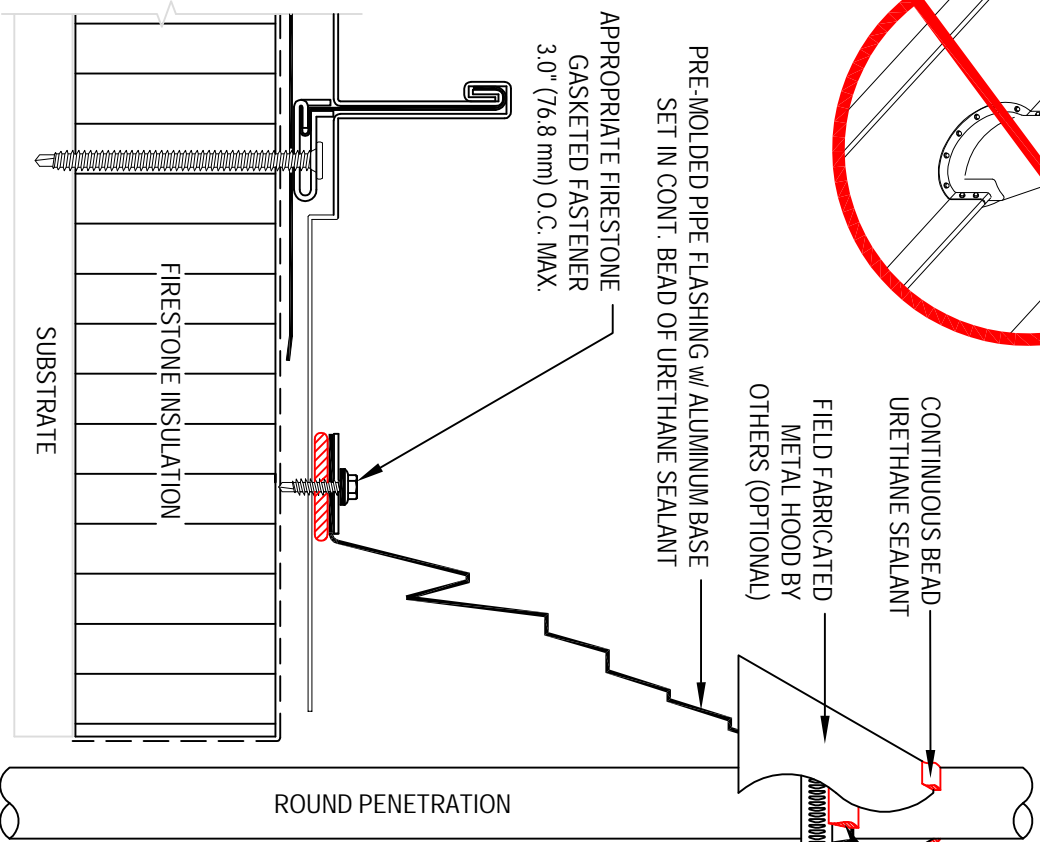

- NOTES:
1. REFER TO FIRESTONE WEBSITE FOR MOST CURRENT INFORMATION.
 2. REMOVE ALL EXISTING FLASHINGS, LEADS, ETC. PIPE SURFACE MUST BE FREE OF ALL RUST, GREASE, INSULATION, ETC.
 3. PIPE MUST BE ANCHORED TO ENSURE STABILITY.
 4. PRE-MOLDED PIPE FLASHING MAY BE CUT TO HEIGHT, BUT NO LOWER THAN REINFORCING RING (NO WRINKLES OR FOLDS UNDER CLAMPING RING).
 5. APPLY LAP SEALANT BETWEEN PENETRATION AND PRE-MOLDED PIPE FLASHING PRIOR TO INSTALLATION OF CLAMPING RING.
 6. REFER TO THE FIRESTONE TECHNICAL DATABASE FOR FASTENER/METAL COMPATIBILITY.
 7. DO NOT USE WHEN SERVICE LINE TEMP. EXCEEDS 180°F.
 8. PIPE SHOULD EXTEND A MINIMUM OF 8" (203.2 mm) ABOVE ROOF SURFACE.
 9. WHERE SNOW AND ICE ARE COMMON, FIRESTONE APPROVED ICE/SNOW-DAM PROTECTION IS RECOMMENDED UP-SLOPE OF PENETRATIONS

MAXIMUM WARRANTY: 20 YEARS

PENETRATION WITH PIPE FLASHING

UNA-CLAD®

ACCEPTABLE SYSTEMS: UC-6 RS

Firestone
BUILDING PRODUCTS
NOBODY COVERS YOU BETTER.™
www.firestonebppco.com

ISSUE / REVISION
DATE:
04/18/2017

NOT TO SCALE

DETAIL NO.
6-P-1