

**USE APPROPRIATE TERMINATION**

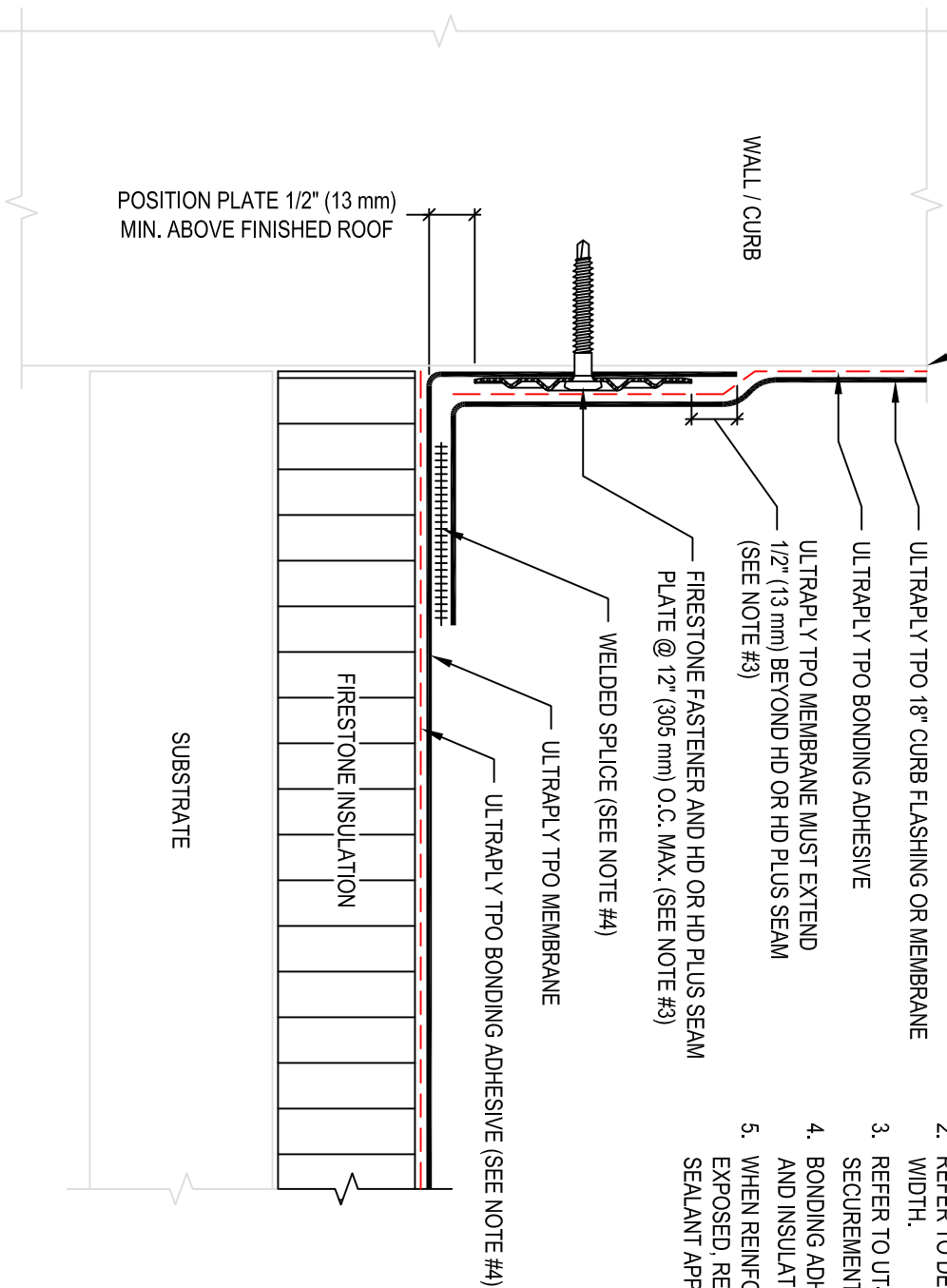

- NOTES:
1. REFER TO FIRESTONE WEBSITE FOR MOST CURRENT INFORMATION.
  2. REFER TO DETAIL UT-LS-1 OR UT-LS-2 FOR WELD WIDTH.
  3. REFER TO UT-BT-16 & UT-BT-17 FOR MEMBRANE SECUREMENT AT CORNERS.
  4. BONDING ADHESIVE REQUIRED BETWEEN MEMBRANE AND INSULATION FOR FULLY ADHERED SYSTEMS.
  5. WHEN REINFORCEMENT OF TPO MEMBRANE IS EXPOSED, REFER TO UT-LS-14 FOR CUT EDGE SEALANT APPLICATION.

**Firestone**  
BUILDING PRODUCTS

**NOBODY COVERS YOU BETTER.™**  
www.firestonebpc.com

**BASE TIE-IN WITH HD SEAM PLATES FASTENED TO WALL / CURB**

ULTRAPLY™ TPO

ACCEPTABLE SYSTEMS: ALL

MAXIMUM WARRANTY: **20 YEARS**

ISSUE / REVISION DATE:

6/26/2014

NOT TO SCALE

DETAIL NO.

**UT-BT-2**