

STEP #1

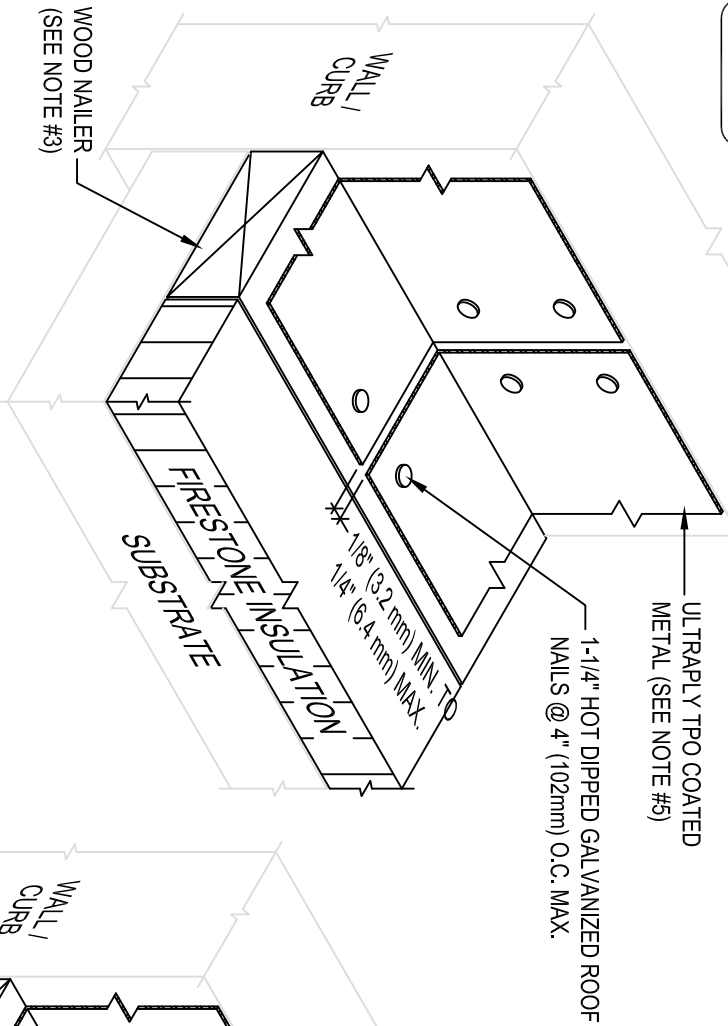

- NOTES:
1. REFER TO FIRESTONE WEBSITE FOR MOST CURRENT INFORMATION.
 2. INSTALL METAL WORK TO SMACNA RECOMMENDATIONS
 3. WOOD NAILER MUST BE INSTALLED TO MEET APPLICABLE BUILDING CODES OR PROVIDE 200 LBS PER LINEAR FOOT IN ANY GIVEN DIRECTION.

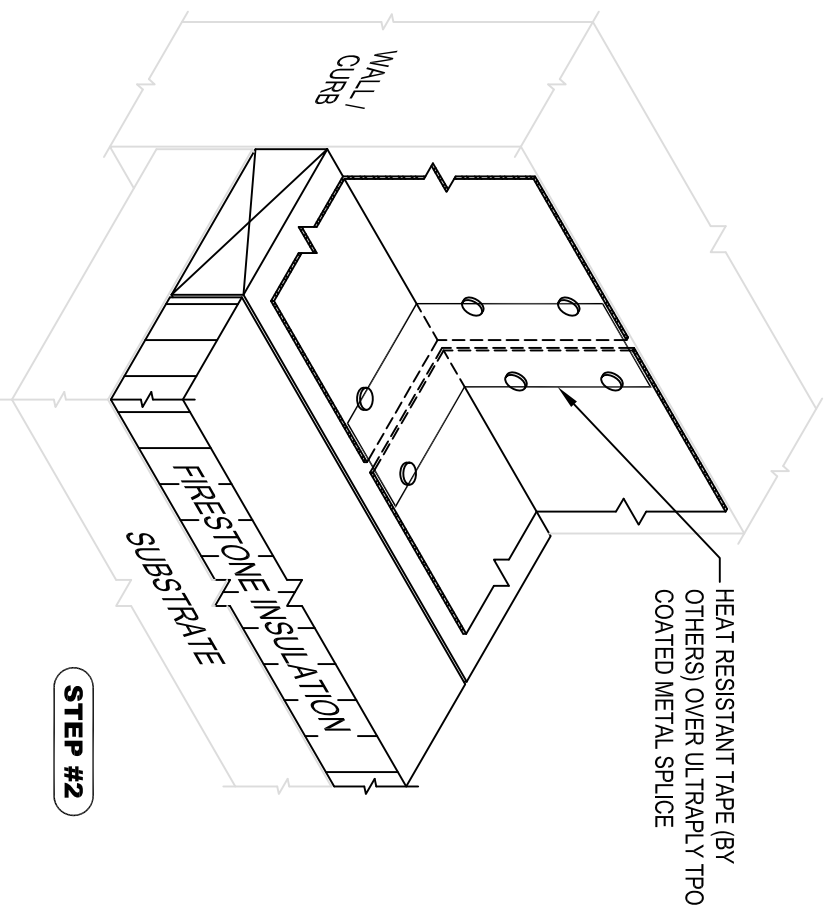

STEP #2

MAXIMUM WARRANTY: **20 YEARS**

DETAIL NO.

UT-BT-11a

**ULTRAPPLY TPO COATED METAL SPLICE
INSTALLATION STEPS 1 & 2**

ULTRAPPLY™ TPO

ACCEPTABLE SYSTEMS: ALL

ISSUE / REVISION
DATE:

7/01/2014

NOT TO SCALE