

**EXTREME CARE SHOULD
BE TAKEN WHEN TORCHING
APP MEMBRANE NEAR
FLAMMABLE MATERIALS**

- NOTES:
- REFER TO FIRESTONE WEBSITE FOR MOST CURRENT INFORMATION.
 - WOOD NAILER MUST BE INSTALLED TO MEET APPLICABLE BUILDING CODES OR PROVIDE 200 PER LINEAL FOOT IN ANY GIVEN DIRECTION.
 - BONDING ADHESIVE REQUIRED BETWEEN MEMBRANE AND INSULATION FOR FULLY ADHERED SYSTEMS.
 - FIRESTONE ROOF PAVES (MIN 10LBS (4.5 KG) PER SQ. FT.) INSTALLED OVER PROTECTION LAYER REQUIRED FOR BALLASTED SYSTEMS.
 - EXISTING GRAVEL SURFACE, IRREGULARITIES, MOISTURE, ETC. MUST BE REMOVED FROM EXISTING ASPHALT SYSTEM MEMBRANE PRIOR TO TIE-IN
 - BATTEN STRIP MAY BE USED IN LIEU OF METAL STRIPS FOR MASS AND FULLY ADHERED SYSTEMS ONLY. REFER TO "UT-BT" DETAILS FOR SPECIFIC BASE TIE-IN INFORMATION, REQUIREMENTS AND OPTIONS.
 - WHEN CHANGE IN ELEVATION OCCURS BETWEEN SYSTEMS, USE APPROPRIATE TAPERED INSULATION TO CREATE A SMOOTH TRANSITION.

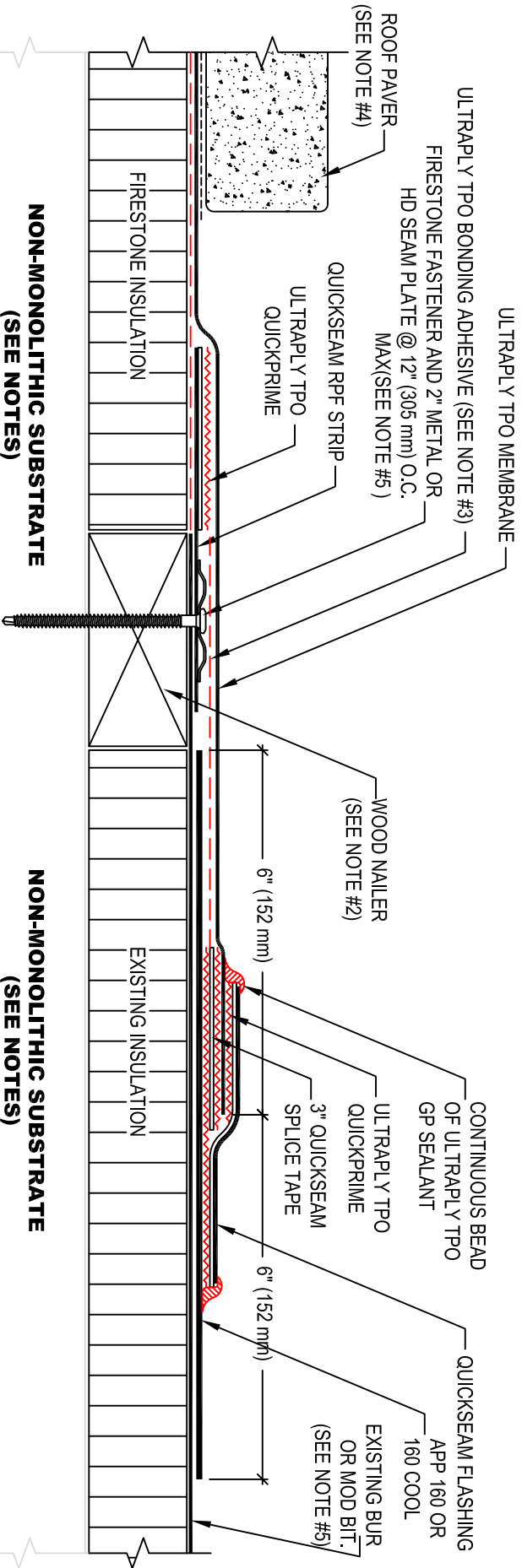

**TIE-IN TO EXISTING ROOF SYSTEMS NOT
WARRANTED BY FIRESTONE**

MAXIMUM WARRANTY: **NONE**

ISSUE / REVISION
DATE:

7/01/2014

DETAIL NO.

UT-BT-23

Firestone
BUILDING PRODUCTS
NOBODY COVERS YOU BETTER.[™]
www.firestonebpc.com

**TIE-IN ULTRAPLY TPO SYSTEM TO EXISTING
ASPHALT SYSTEM (NON-MONOLITHIC SUBSTRATE)**

ULTRAPLY[™] TPO

ACCEPTABLE SYSTEMS: ALL

NOT TO SCALE