

COMPRESSIBLE TUBE (SEE NOTE #3)

COMPRESSIBLE INSULATION WITH INSULATION RETAINER AND FASTENER REQUIRED (SUPPLIED BY OTHERS) (SEE NOTE #3)

FIRESTONE FASTENER AND 2" METAL OR HD SEAM PLATE @ 12" (305 mm) O.C. MAX. (SEE NOTES #5)

WELDED SPLICE (SEE NOTE #2 & #7)

ULTRAPLY TPO MEMBRANE

ULTRAPLY TPO BONDING ADHESIVE (SEE NOTE #4)

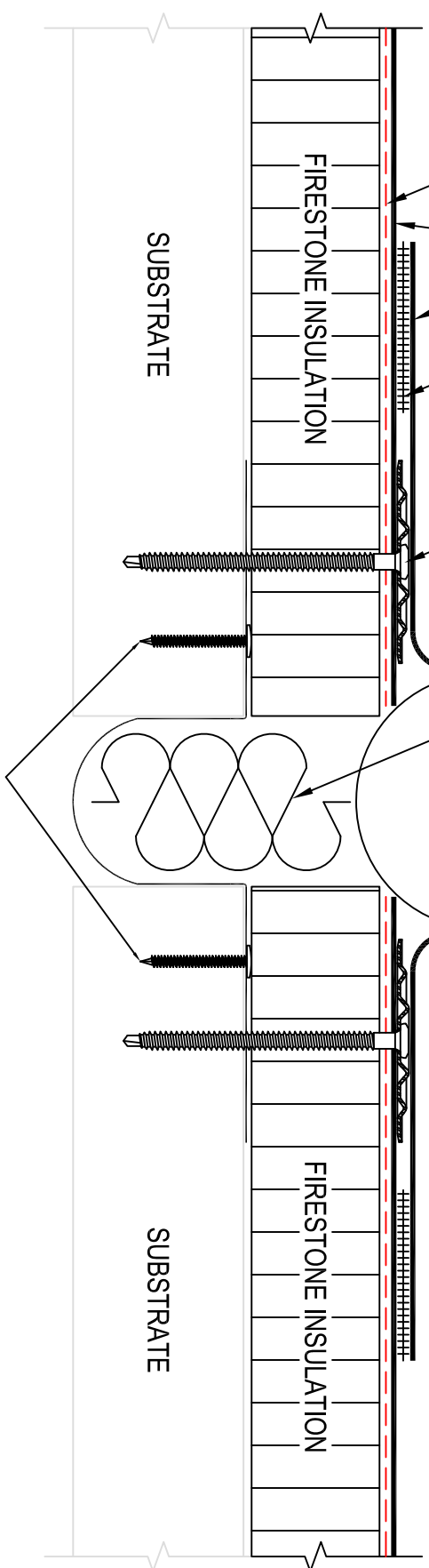

- NOTES:
1. REFER TO FIRESTONE WEBSITE FOR MOST CURRENT INFORMATION.
 2. REFER TO DETAIL UT-L-S-1 OR UT-L-S-2 FOR WELD WIDTH.
 3. COMPRESSIBLE TUBE (SUPPLIED BY OTHERS) DIAMETER MUST EXCEED THE DECK OPENING BY 50% MIN. OR DESIGNED MOVEMENT (WHICH EVER IS GREATER).
 4. BONDING ADHESIVE REQUIRED BETWEEN MEMBRANE AND INSULATION FOR FULLY ADHERED SYSTEM.
 5. MAXIMUM 6" (152 mm) LONG FASTENERS. (NOTE: WOOD BLOCKING MAY BE SUBSTITUTED FOR INSULATION TO REDUCE FASTENER LENGTH REQUIREMENTS.
 6. WHEN REINFORCEMENT OF TPO MEMBRANE IS EXPOSED, REFER TO UT-L-S-14 FOR CUT EDGE SEALANT APPLICATION.
 7. REFER TO UT-L-S-15 FOR ADDITIONAL LAP SPLICE REQUIREMENTS.

Firestone
 BUILDING PRODUCTS
 NOBODY COVERS YOU BETTER.™
 www.firestonebpc.com

EXPANSION JOINT (FIELD FABRICATED) WITH WELDED SPLICE - ROOF TO ROOF

ULTRAPLY™ TPO

ACCEPTABLE SYSTEMS: ALL

ISSUE / REVISION
 DATE: 7/22/2014

DETAIL NO. **UT-E-6**

MAXIMUM WARRANTY: **20 YEARS**