

- NOTES:
1. REFER TO FIRESTONE WEBSITE FOR MOST CURRENT INFORMATION.
 2. FIRESTONE RED SHIELD PIPE AND EQUIPMENT SUPPORTS ARE RECOMMENDED IN PLACE OF WOOD SLEEPERS. REFER TO CURRENT TECHNICAL INFORMATION SHEETS.
 3. DO NOT INSTALL WOOD SLEEPERS OVER BATTEN STRIPS, FASTENERS HEADS, METAL PLATES OR FIELD SEAMS.

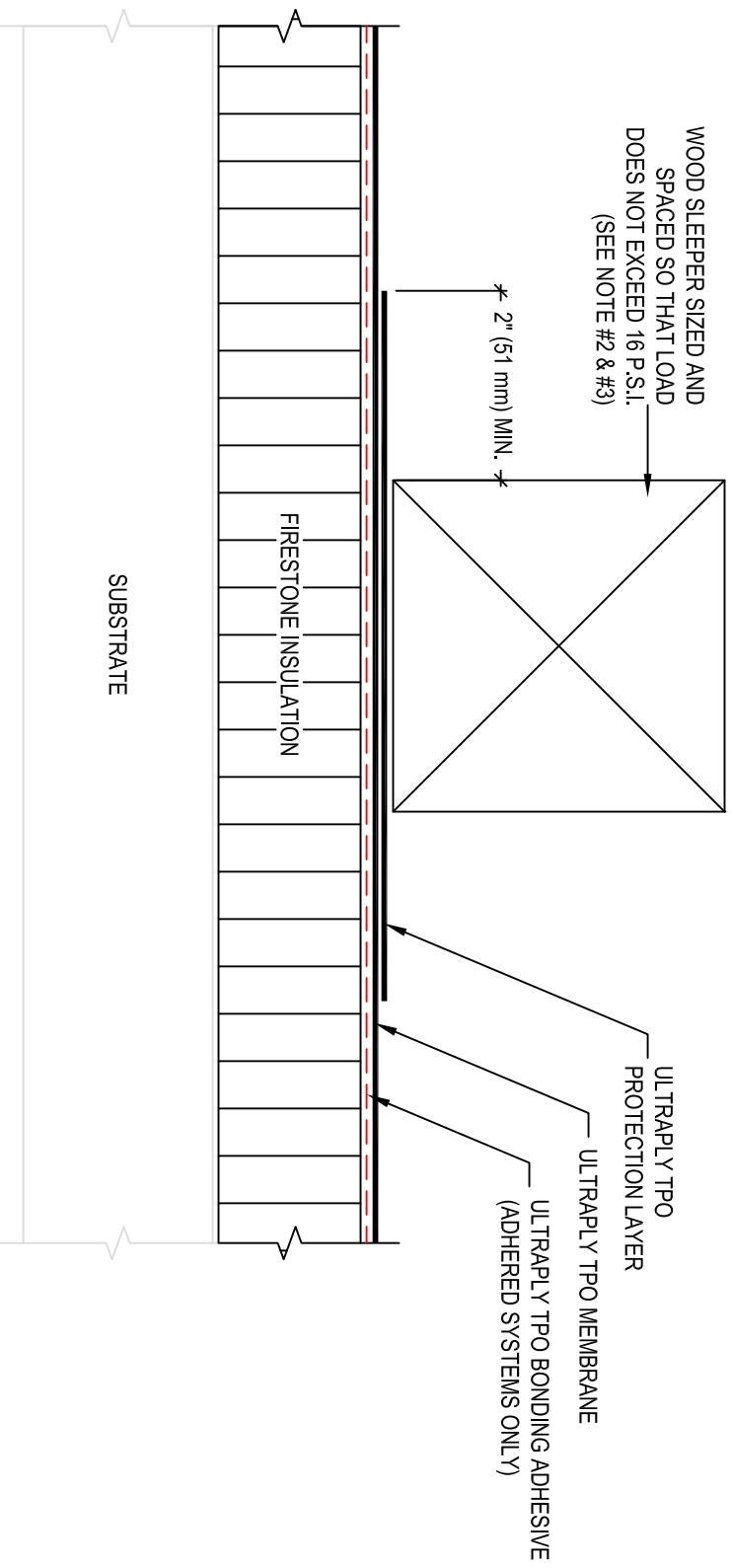

Firestone
 BUILDING PRODUCTS
 NOBODY COVERS YOU BETTER.™
 www.firestonebpc.com

WOOD SLEEPER

ULTRAPLY™ TPO

ACCEPTABLE SYSTEMS: ALL

ISSUE / REVISION
 DATE: 7/22/2014
 NOT TO SCALE

MAXIMUM WARRANTY: **20 YEARS**

DETAIL NO. **UT-M-4**