

- NOTES:
1. REFER TO FIRESTONE WEBSITE FOR THE MOST CURRENT INFORMATION.
 2. REMOVE ALL EXISTING FLASHING, LEAD, ETC. PIPE SURFACE MUST BE FREE OF ALL RUST, GREASE, INSULATION, ETC.
 3. FIRESTONE POURABLE SEALER MOUNTED TO SHED WATER (MINIMUM DEPTH OF 2" (51 mm), REMAINDER OF POCKET MAY BE FILLED WITH A NON-SHRINKING GROUT.
 4. DO NOT USE OVER EXISTING PENETRATION POCKETS.
 5. DO NOT USE WHEN SERVICE LINE TEMP. EXCEEDS 180°F. REFER TO UT-P-6 & UT-P-7.
 6. CUT PVC PIPE MINIMUM 2" (50 mm) HIGH AND OF SUFFICIENT WIDTH TO ALLOW 1" (25 mm) OF SPACE BETWEEN PENETRATIONS AND BETWEEN THE PVC SHELL AND PENETRATIONS. MEMBRANE MUST EXTEND TO WITH IN 1/2" (13 mm) OF PENETRATIONS.
 7. IF FIELD MEMBRANE IS CUT FOR INSULATION, THE MEMBRANE MUST BE REPAIRED WITH TPO MEMBRANE PRIOR TO INSTALLATION OF THE PENETRATION POCKETS.
 8. ULTRAPLY TPO QUICKPRIME REQUIRED ON PENETRATIONS AND MEMBRANE INSIDE OF PENETRATIONS.
 9. REFER TO UT-P-15 OR UT-P-16 FOR MAS.

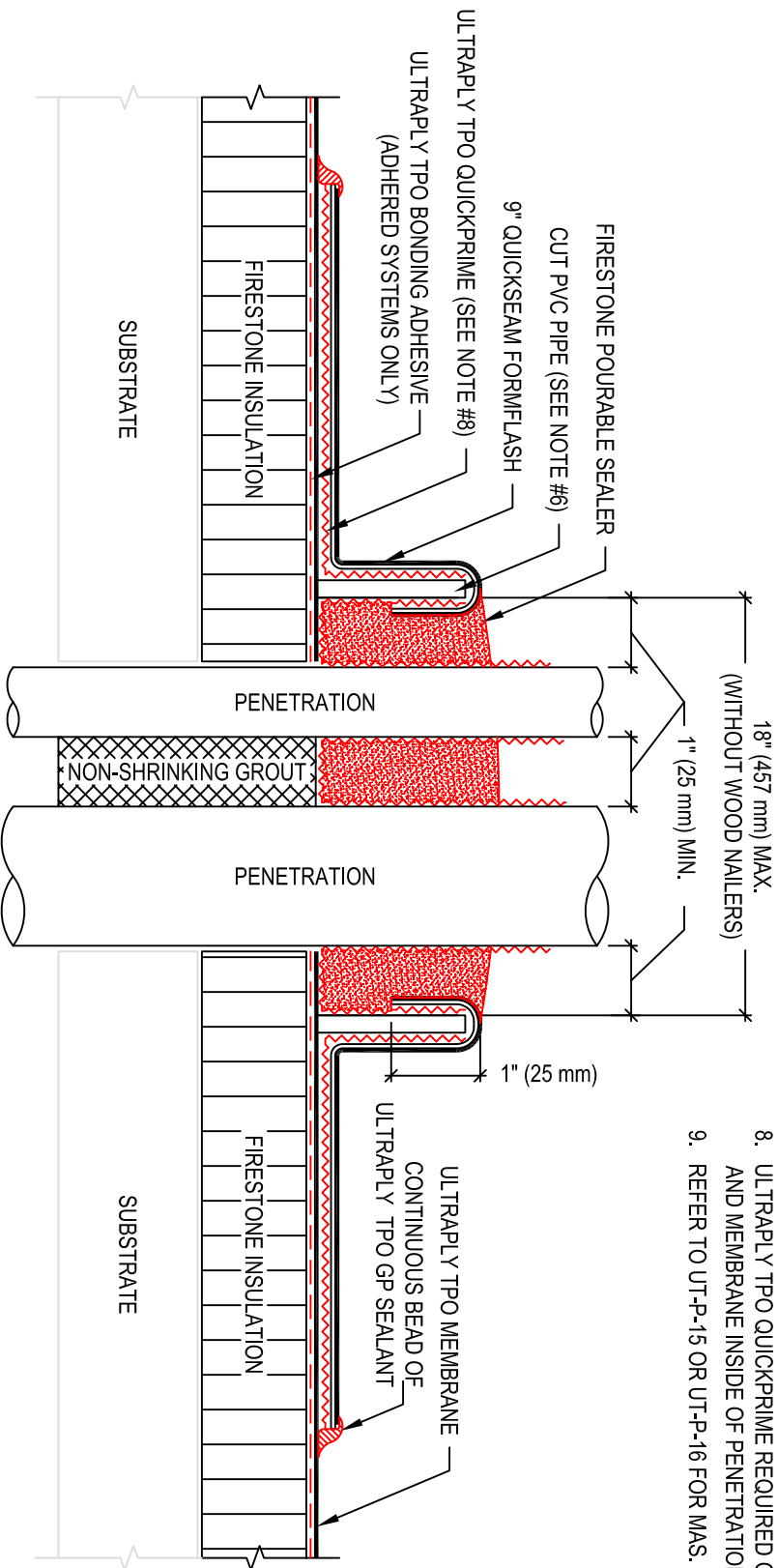

MAXIMUM WARRANTY: **15 YEARS**

PENETRATION WITH FIELD FABRICATED ROUND

PVC PENETRATION POCKET

ULTRAPLY™ TPO

ACCEPTABLE SYSTEMS: ALL

ISSUE / REVISION
DATE:

7/22/2014

DETAIL NO.

UT-P-10

NOT TO SCALE