

- NOTES:
1. REFER TO FIRESTONE WEBSITE FOR THE MOST CURRENT INFORMATION.
 2. GP SEALANT IS REQUIRED ALONG ENTIRE UPSLOPE EDGE OF QUICKSEAM FLASHING WHEN ROOF SLOPE IS THAN 1" (25 mm) PER FOOT OR GREATER.
 3. WOOD NAILER MUST BE INSTALLED TO MEET APPLICABLE BUILDING CODES OR 200 LBS PER LINEAR FOOT MINIMUM IN ANY GIVEN DIRECTION.
 4. FLANGE OF METAL MUST BE FULLY SUPPORTED BY WOOD AND TERMINATED AT LEAST 1/2" (13 mm) FROM EDGE OF WOOD.

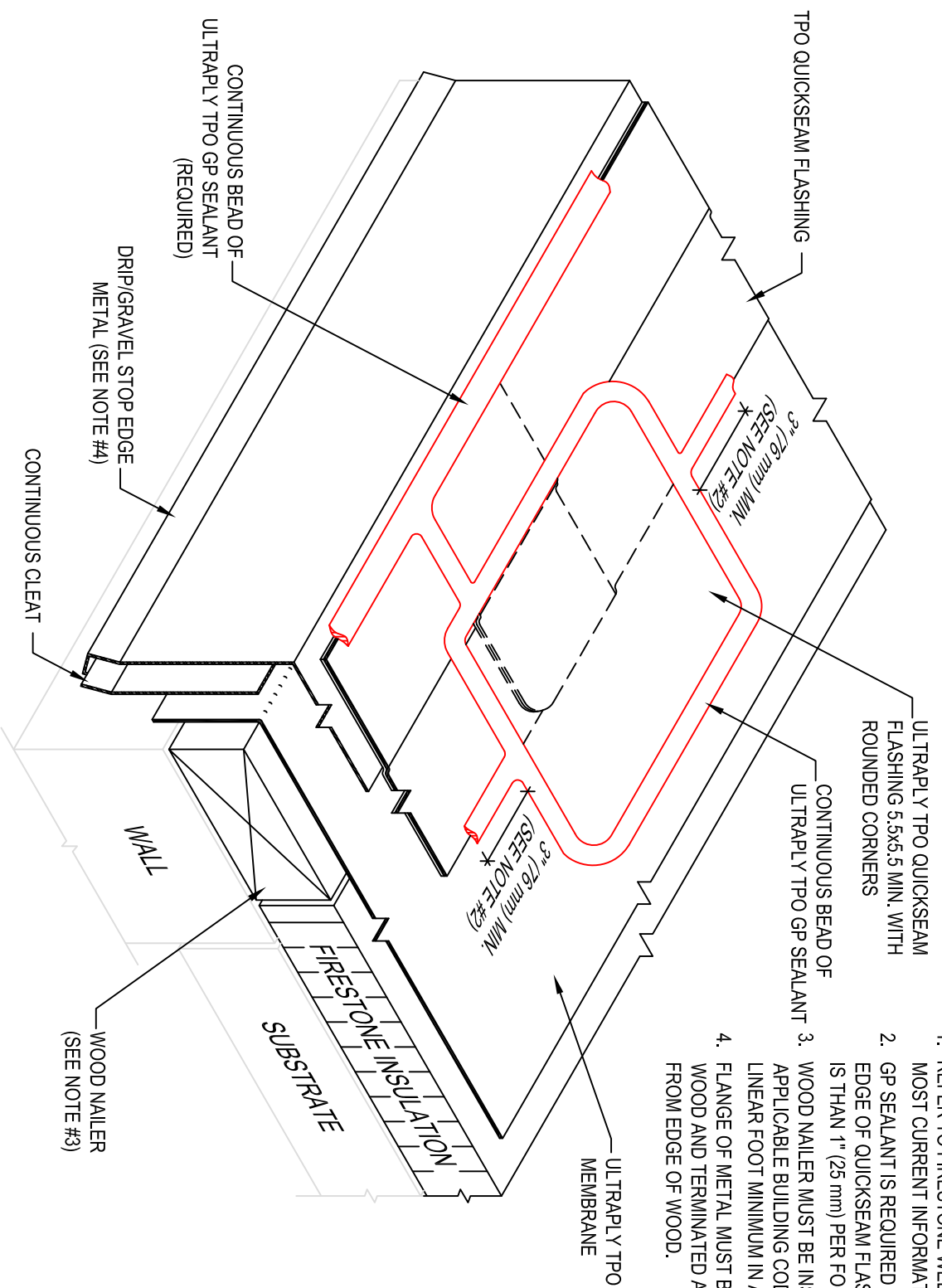

Firestone
BUILDING PRODUCTS

NOBODY COVERS YOU BETTER.™
www.firestonebppco.com

**ROOF EDGE WITH TPO QUICKSEAM FLASHING
END SPICE OVERLAP**

ULTRAPLY™ TPO

ACCEPTABLE SYSTEMS: ALL

MAXIMUM WARRANTY: **20 YEARS**

ISSUE / REVISION
DATE:

6/25/2014

NOT TO SCALE

DETAIL NO.

UT-RE-24