

**USE APPROPRIATE TERMINATION**

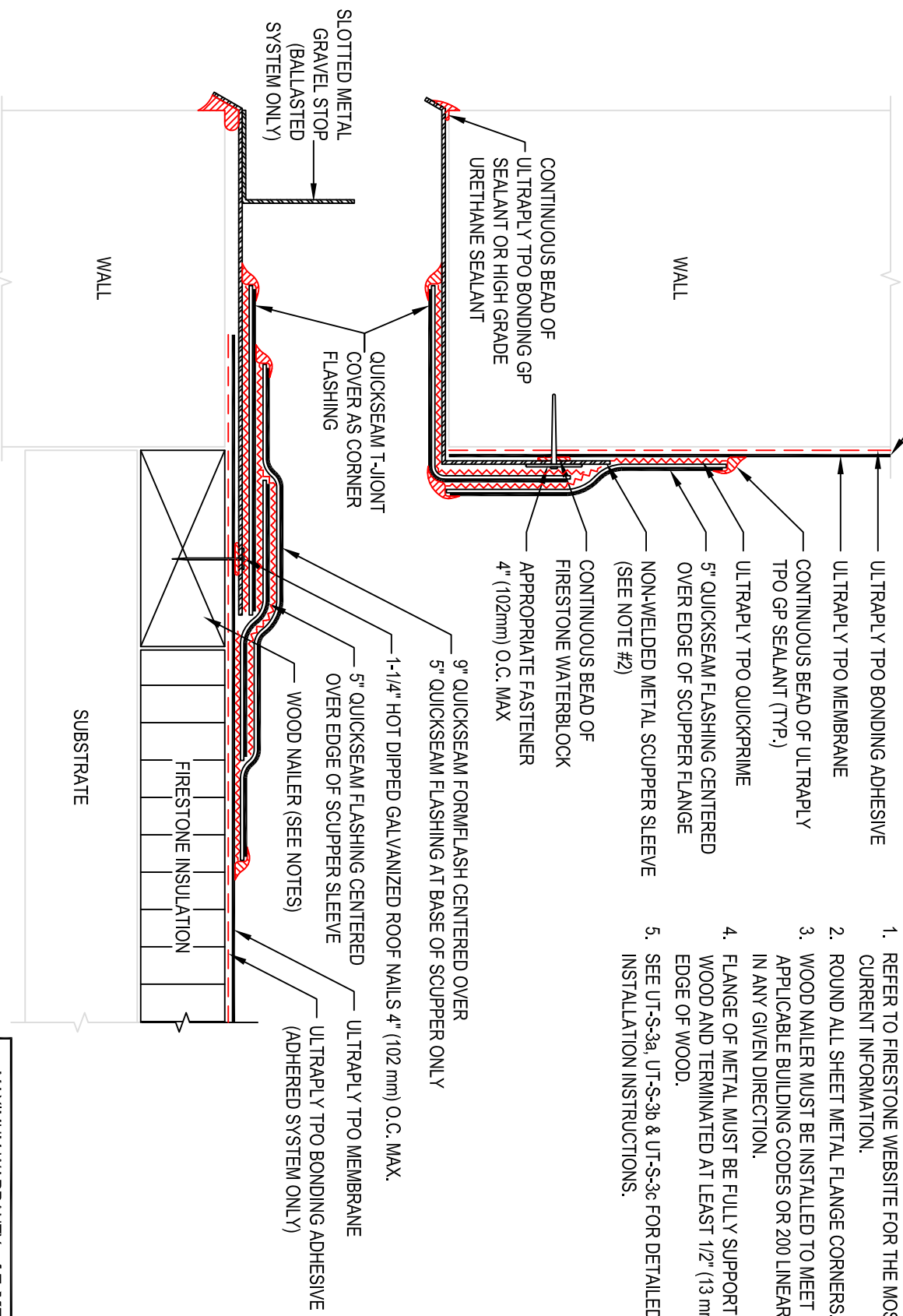

- NOTES:
1. REFER TO FIRESTONE WEBSITE FOR THE MOST CURRENT INFORMATION.
  2. ROUND ALL SHEET METAL FLANGE CORNERS.
  3. WOOD NAILER MUST BE INSTALLED TO MEET APPLICABLE BUILDING CODES OR 200 LINEAR 200 LBS IN ANY GIVEN DIRECTION.
  4. FLANGE OF METAL MUST BE FULLY SUPPORTED BY WOOD AND TERMINATED AT LEAST 1/2" (13 mm) FROM EDGE OF WOOD.
  5. SEE UT-S-3a, UT-S-3b & UT-S-3c FOR DETAILED INSTALLATION INSTRUCTIONS.

**Firestone**  
 BUILDING PRODUCTS  
 NOBODY COVERS YOU BETTER.™  
 www.firestonebpc.com

**THRU-WALL SCUPPER (NON-WELDED SLEEVE)**  
 ULTRAPLY™ TPO  
 ACCEPTABLE SYSTEMS: ALL

ISSUE / REVISION  
 DATE: 7/22/2014

MAXIMUM WARRANTY: **15 YEARS**  
 DETAIL NO. **UT-S-3**

NOT TO SCALE