

**MASONRY AND CONCRETE WALLS MUST BE WATERPROOFED AND MAINTAINED IN ORDER FOR ANY SURFACE MOUNTED TERMINATION TO BE EFFECTIVE**

- NOTES:
1. REFER TO FIRESTONE WEBSITE FOR MOST CURRENT INFORMATION.
  2. TERMINATION BAR MUST BE CUT AT EACH WALL JOINT AND SECURED TO THE SUBSTRATE WITH APPROPRIATE FIRESTONE FASTENER. REFER TO UT-T-1 FOR APPLICATION OF WATERBLOCK AND TERMINATION BAR INSTALLATION SPECIFICATIONS.
  3. IF FIRESTONE MASONRY FASTENER IS USED, FASTENER MUST BE INSTALLED WITH SLOT HORIZONTAL.
  4. FIRESTONE FASTENERS 12" (305 mm) O.C. MAX. OR AS REQUIRED TO PROVIDE COMPRESSION ON THE TERMINATION BAR.

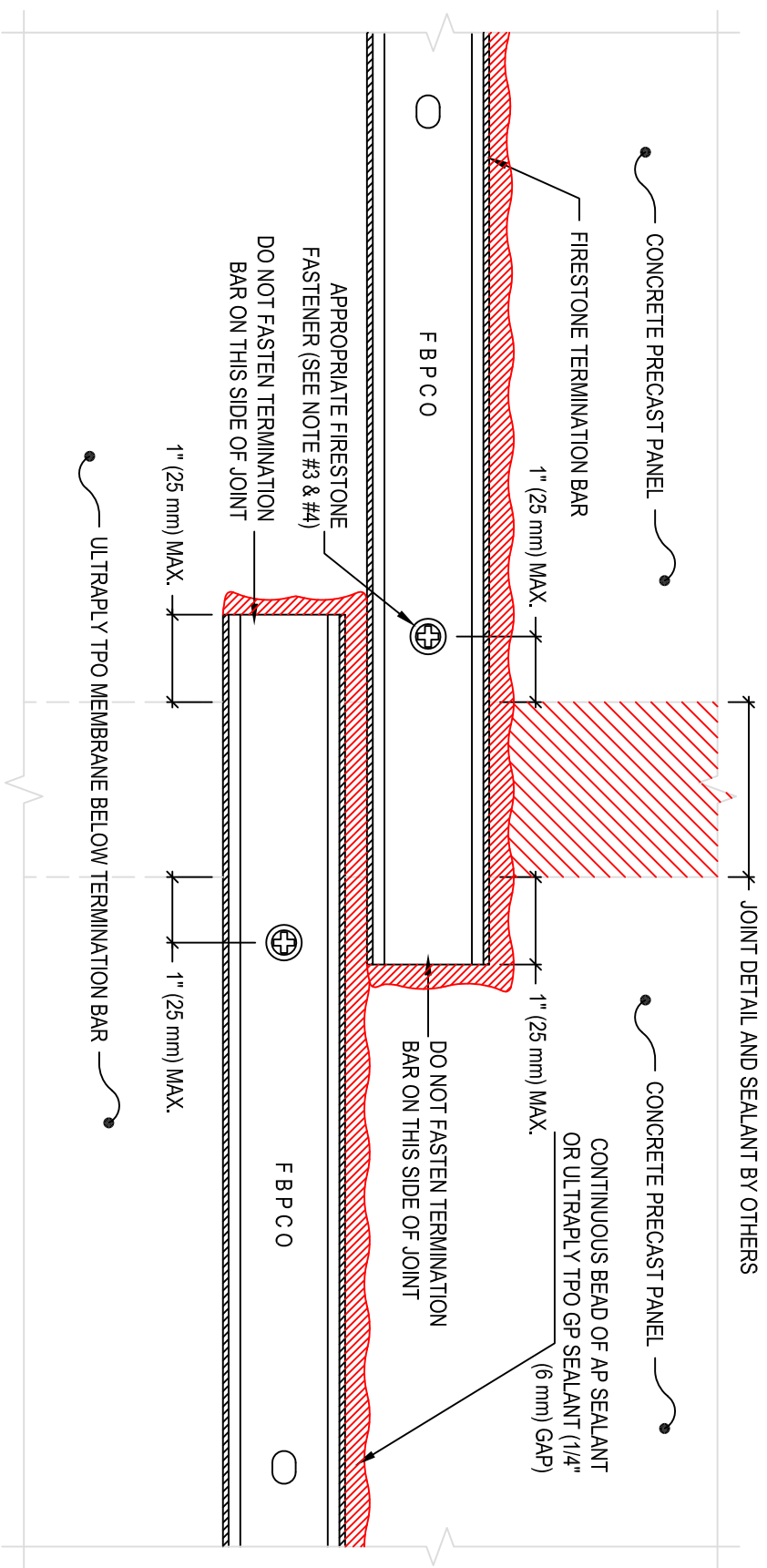

**Firestone**  
BUILDING PRODUCTS

**NOBODY COVERS YOU BETTER.™**  
www.firestonebpc.com

**TERMINATION AT TILT-UP WALL JOINT**

ULTRAPPLY™ TPO

ACCEPTABLE SYSTEMS: ALL

MAXIMUM WARRANTY: **20 YEARS**

ISSUE / REVISION  
DATE:

7/22/2014

DETAIL NO.

**UT-T-9**

NOT TO SCALE