

- NOTES:
1. REFER TO FIRESTONE WEBSITE FOR MOST CURRENT INFORMATION.
 2. WOOD NAILER MUST BE INSTALLED TO MEET APPLICABLE BUILDING CODES OR PROVIDE 200 PER LINEAL FOOT IN ANY GIVEN DIRECTION.
 3. BONDING ADHESIVE REQUIRED BETWEEN MEMBRANE AND INSULATION FOR FULLY ADHERED SYSTEMS.
 4. FIRESTONE ROOF PAVER (MIN 10LBS (4.5KG) PER SQ. FT.) INSTALLED OVER PROTECTION LAYER REQUIRED FOR BALLASTED SYSTEMS.
 5. REFER TO UT-BT-24 FOR ADDITIONAL REQUIREMENTS FOR METAL ROOF DECKS
 6. BATTEN STRIP MAY BE USED IN LIEU OF METAL STRIPS FOR MASS AND FULLY ADHERED SYSTEMS ONLY. REFER TO "UT-BT" DETAILS FOR SPECIFIC BASE TIE-IN INFORMATION, REQUIREMENTS AND OPTIONS.
 7. WHEN CHANGE IN ELEVATION OCCURS BETWEEN SYSTEMS, USE APPROPRIATE TAPERED INSULATION TO CREATE A SMOOTH TRANSITION.

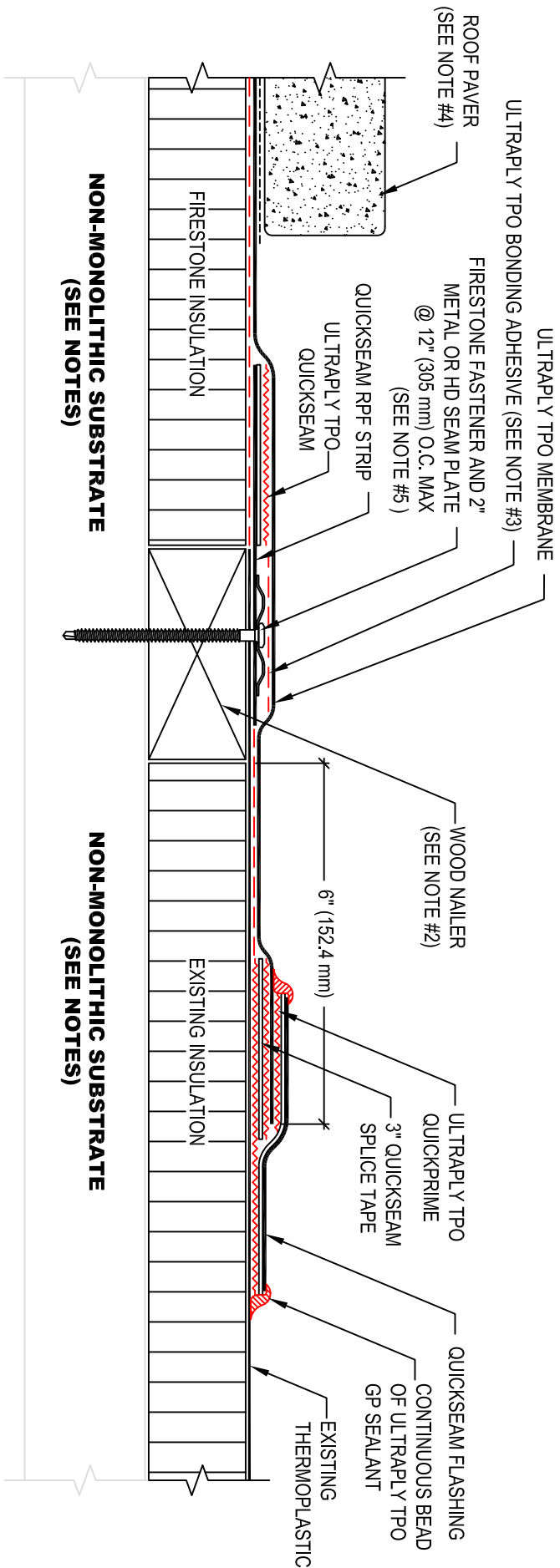

TIE-IN TO EXISTING ROOF SYSTEMS NOT WARRANTED BY FIRESTONE

MAXIMUM WARRANTY: **NONE**

DETAIL NO.

UT-BT-19

TIE-IN ULTRAPLY TPO SYSTEM TO EXISTING THERMOPLASTIC SYSTEM (NON-MONOLITHIC SUBSTRATE)

ULTRAPLY™ TPO ACCEPTABLE SYSTEMS: ALL

Firestone
BUILDING PRODUCTS

NOBODY COVERS YOU BETTER.™
www.firestonebpc.com

ISSUE / REVISION DATE:
7/01/2014

NOT TO SCALE